



FAT BOY™

EST 1273

# LAUNCHABLES™

MODEL ROCKET KIT

13 in. (33 cm) Long  
BIG BODY ROCKET

FAT BOY

■ Simple to Glue & Paint!

■ Develops Modeling Skills!

■ Great for School & Scout Projects!

■ Launches to 325 Feet! (99 m)

Recommended for Ages  
10 and Up with Adult  
Supervision for Those  
Under 12.



1 MODÈLE RÉDUIT,  
PEINTURE ET COLLE  
NON COMPRISES.

Made In China



Call 1-800-63-SPACE  
Reference ESR02, or Visit  
[www.spacecamp.com](http://www.spacecamp.com)

Building & Launch Supplies Not Included.



[www.estesrockets.com](http://www.estesrockets.com)

Length: 13 in. (33 cm)  
Diameter: 2.6 in. (66 mm)  
Weight: 3.0 oz. (85 g)  
Recommended Engines:  
B4-2, B6-2, C6-3

# FAT BOY™

MODEL ROCKET KIT

This model kit requires assembly.  
Requires hobby tools, wood glue,  
finishing supplies, engines, igniters,  
wadding and launch system - not  
included.

1 MODÈLE RÉDUIT,  
PEINTURE ET COLLE NON COMPRISES.  
Use only with Estes® Products.

Recommended for Ages 10 and Up with  
Adult Supervision for Those Under 12.





ESTES INDUSTRIES  
1295 H Street  
Penrose, CO 81240  
PRINTED IN CHINA



(11/00) 82123

EST 2139

# FAT BOY™ MODEL ROCKET KIT INSTRUCTIONS

**TOOLS REQUIRED:** PENCIL, SANDPAPER, SANDING SEALER, RULER, PAINT BRUSH, HOBBY KNIFE, MASKING TAPE, SCISSORS, GLUE (WHITE OR YELLOW), SPRAY PAINT (ENAMEL GLOSS WHITE, LIGHT BLUE AND RED), ROCKET BUILDER'S MARKING GUIDE (OPTIONAL)

ALL GLUED AREAS ARE SHADED IN GRAY

## PARTS LAYOUT

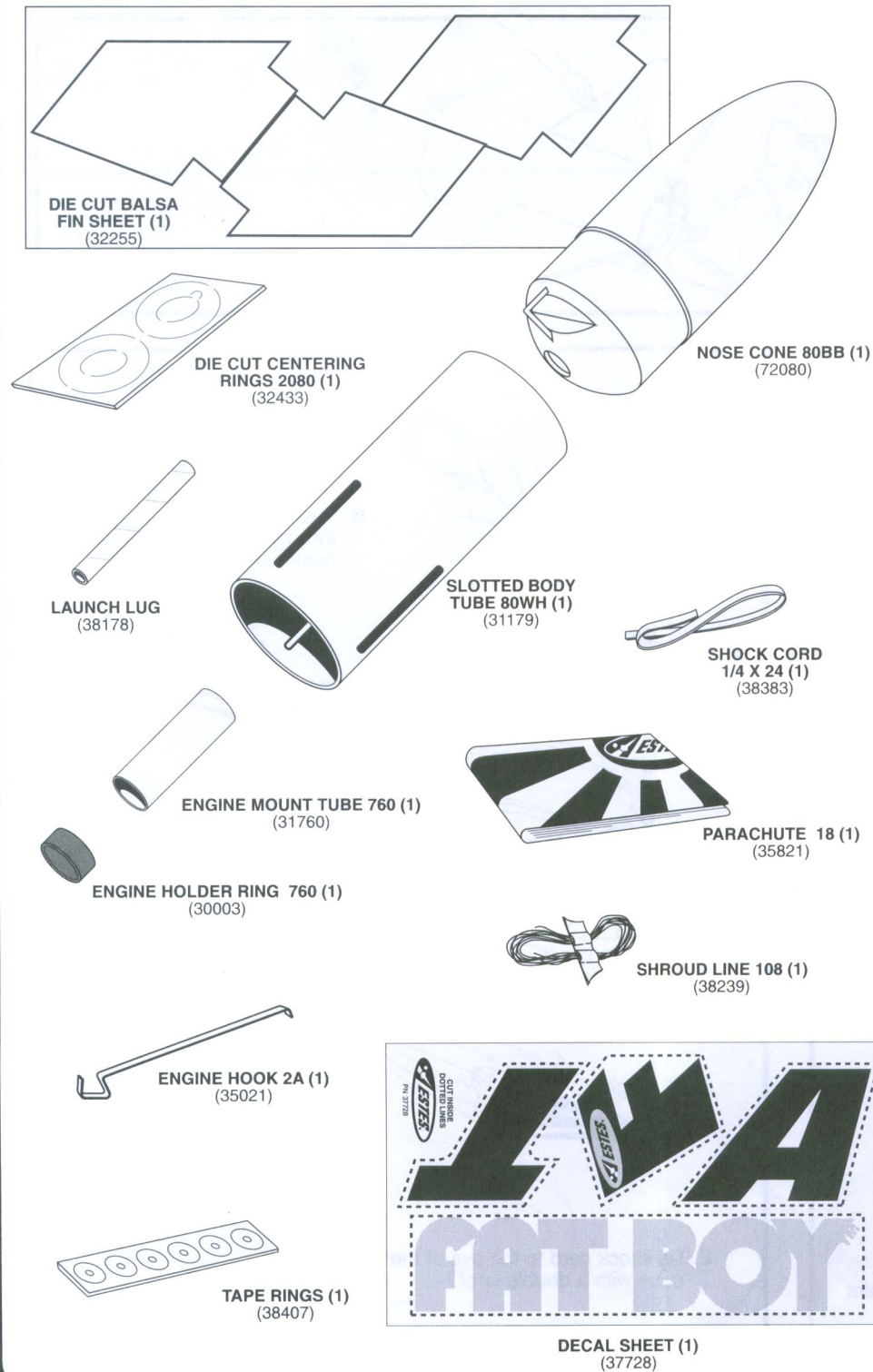

1.

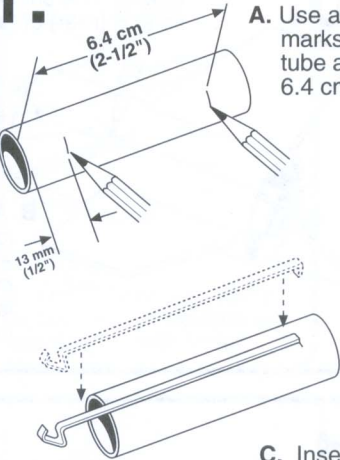

A. Use a pencil to make two marks on the engine mount tube at 13mm (1/2") and at 6.4 cm (2-1/2")

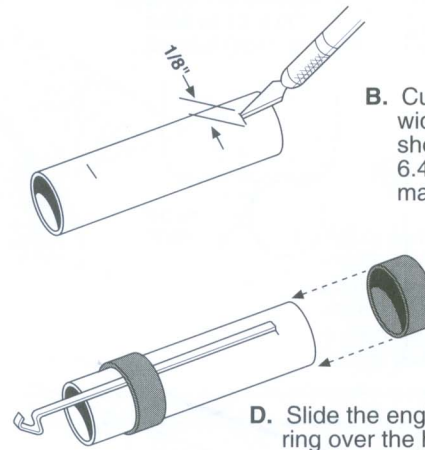

B. Cut a 3 mm (1/8") wide slit (as shown) at the 6.4 cm (2-1/2") mark only.

C. Insert the engine hook into slit as shown.

D. Slide the engine holder ring over the hook and onto the engine mount tube to the 13 mm (1/2") mark. This will secure the engine hook.

2.

A. Carefully remove the centering rings from their card. Use a hobby knife to finish the cuts.

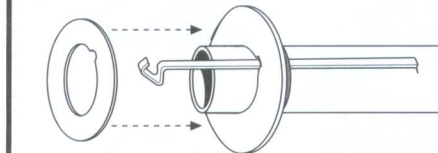
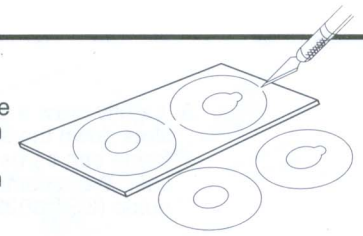

B. Slide centering ring with notch onto the engine mount tube (with notch over engine hook) until the ring is against the engine holder ring.

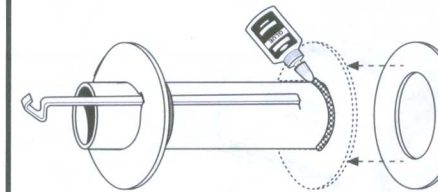

C. Apply glue to end of tube. Slide other ring onto glue. Make ring flush with end of tube.

3.

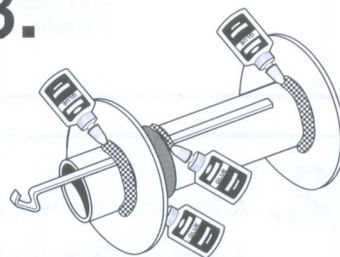

D. Apply a glue reinforcement (fillet) to both sides of ring joints and engine holder ring. Smooth with finger.

4.

A. Cut out parachute on dotted line.



B. Find shroud line material. Remove tape. Using all of the shroud line, fold and cut into three equal lengths.



C. Press tape rings onto marks on corners.



D. Punch holes with sharp pencil.



E. Tie lines off with double knots.



COMPLETED PARACHUTE

5.

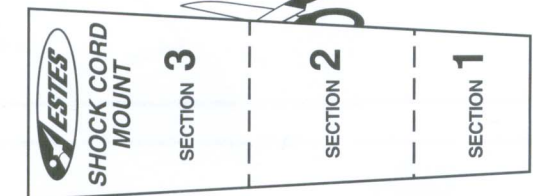

A. Cut out shock cord mount (above) along solid lines. Crease dotted lines.

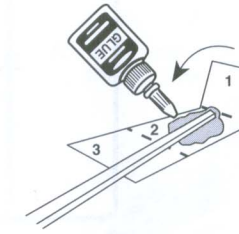

B. Spread glue on section 2 and lay shock cord into glue at a slight angle as shown.

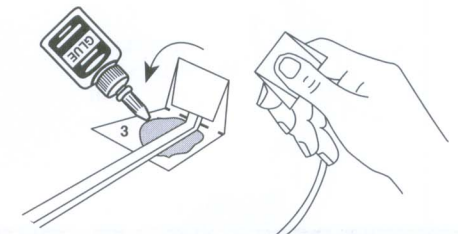

C. Apply glue to section 3. Fold forward again. Clamp firmly until glue sets.

6.

A. Apply glue to shock cord mount.

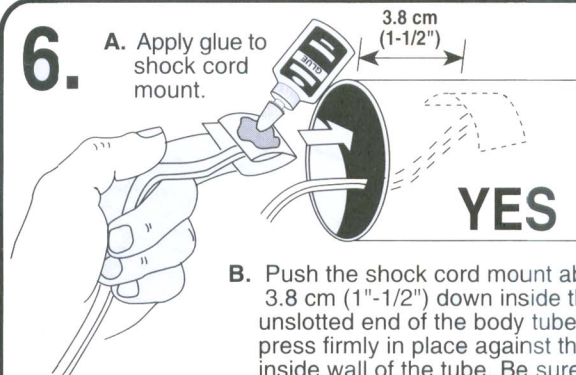

YES

B. Push the shock cord mount about 3.8 cm (1-1/2") down inside the unslotted end of the body tube and press firmly in place against the inside wall of the tube. Be sure it is glued securely in place.

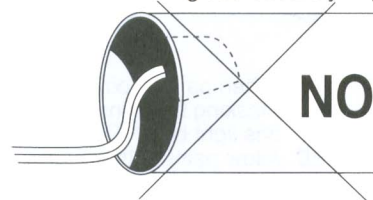

NO

7.

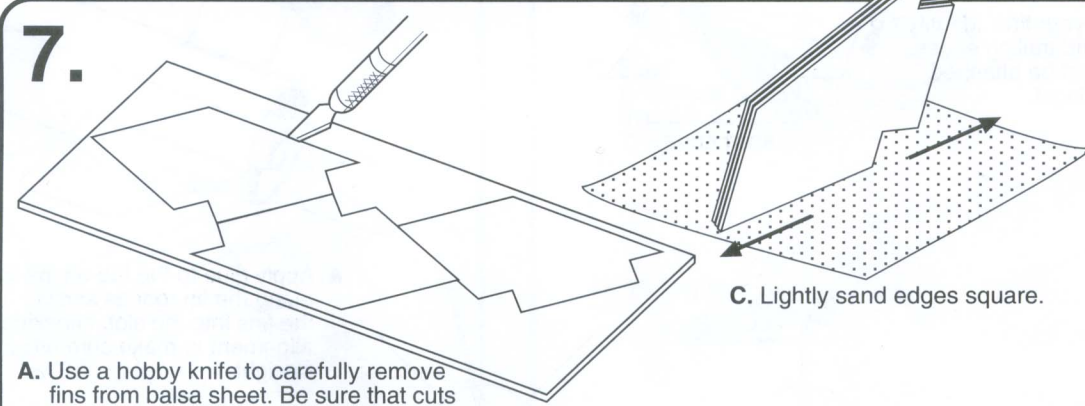

A. Use a hobby knife to carefully remove fins from balsa sheet. Be sure that cuts go completely through the balsa.

NOTE: AS YOU CUT EACH FIN, CUT AWAY FROM ADJACENT FINS SO YOU WON'T DAMAGE THEM.

B. Keep a scrap piece of balsa for a glue applicator.

C. Lightly sand edges square.

D. When your engine mount is dry, test fit your fins as shown.

DO NOT GLUE YET!

8.

A. Lightly draw a straight line between two slots down the slotted body tube. A door frame can be used to make the straight line. We recommend the Estes marking guide (EST 302227).

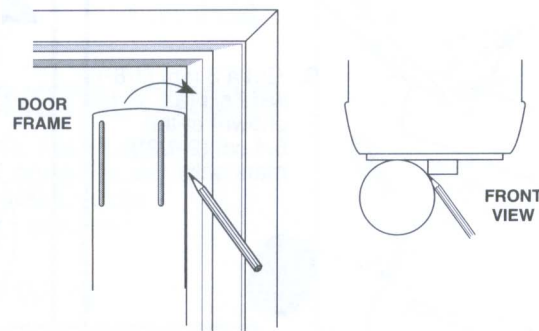

B. Using the scrap balsa stick, apply glue inside rear of body tube just in front of slots.

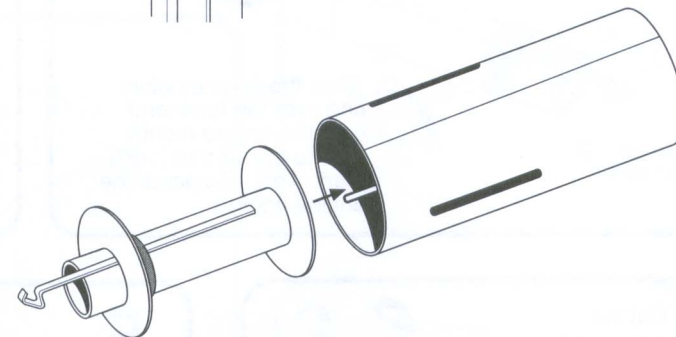
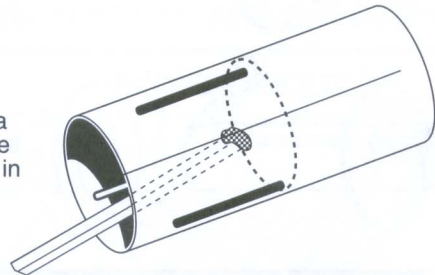

C. Slide engine mount into body tube so that slots are centered between centering rings and engine hook is aligned with the straight line you drew on body tube.

D. Apply glue fillet around the ring/tube joint.

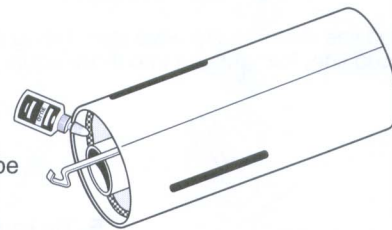

9.

NOTE: Before gluing your fins, identify the root, leading, and trailing edges. REMEMBER: Fins must be attached correctly for stable flight.

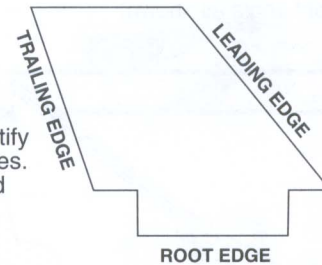

YES

REAR VIEW

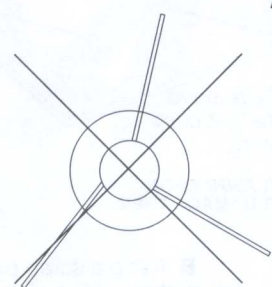

NO

A. Apply glue to the tab on the fins and along the fin root as shown. Insert the fins into the slot, checking alignment to make sure fins are straight.

B. Allow fins to set.

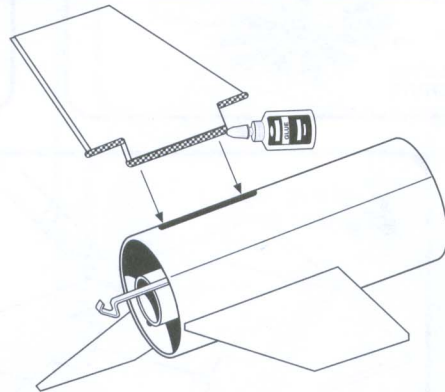

10.

A. Mark the straight line on the body tube at 11.4 cm (4-1/2") from the fin end (rear) of tube.

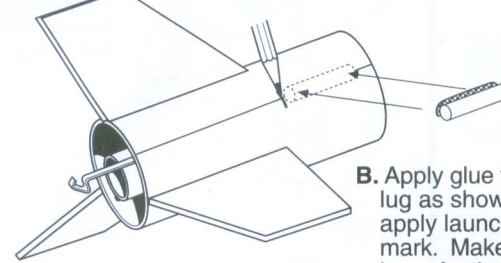

B. Apply glue to launch lug as shown and apply launch lug to mark. Make sure lug is perfectly aligned before glue sets.

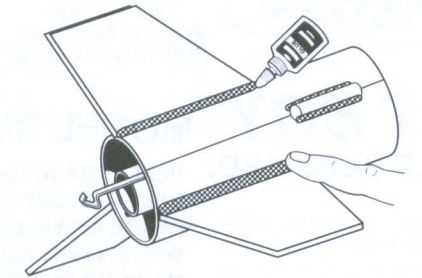
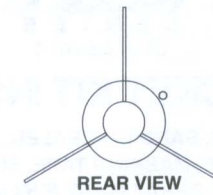

C. After glue is completely dry, apply a glue fillet to both sides of launch lug and fins. Smooth glue with finger.

11.

A. Apply sanding sealer to balsa wood fins. B. When sealer is dry, lightly sand. Repeat sealing and sanding until balsa grain is filled and smooth.

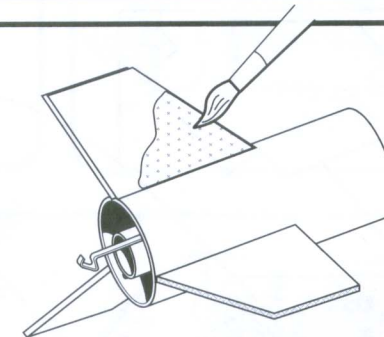

12.

A. Paint entire model with gloss white.

B. After paint is dry, mask off fins and paint rocket body red.

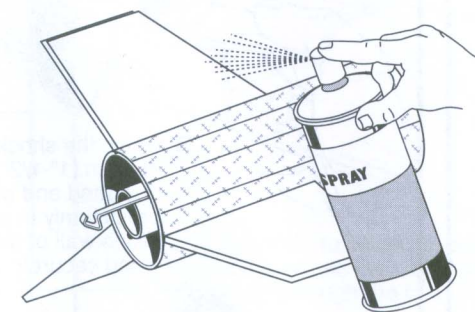
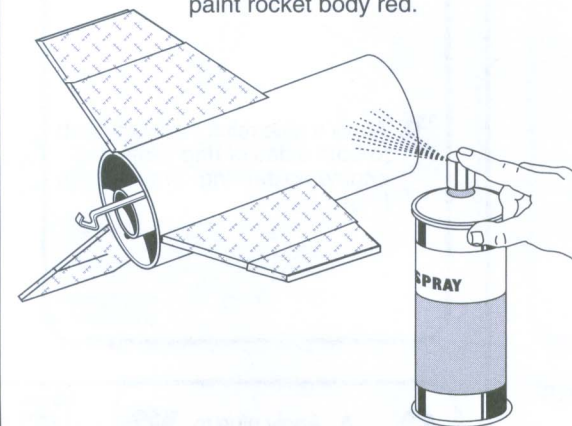

C. When paint is completely dry, remove masking from fins and mask off body. Paint fins light blue. D. Allow paint to thoroughly dry and remove masking tape.

13.

A. Form loop with shroud lines.

B. Push loop through eye of nose cone.

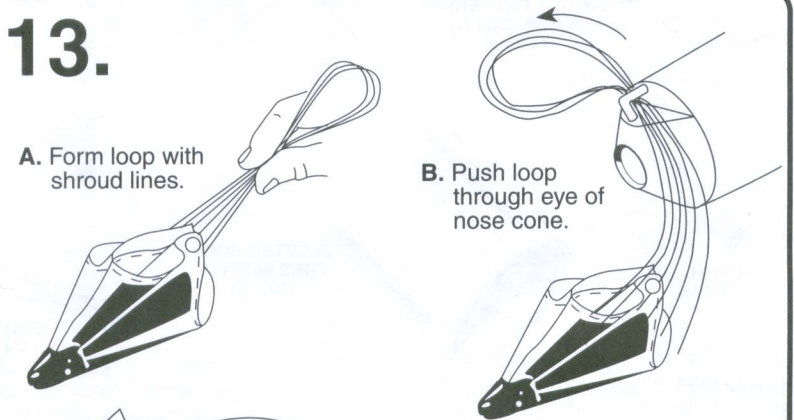

C. Pass parachute through loop.

D. Pull tight.

E. Tie shock cord to the eye of the nose cone with a double knot.

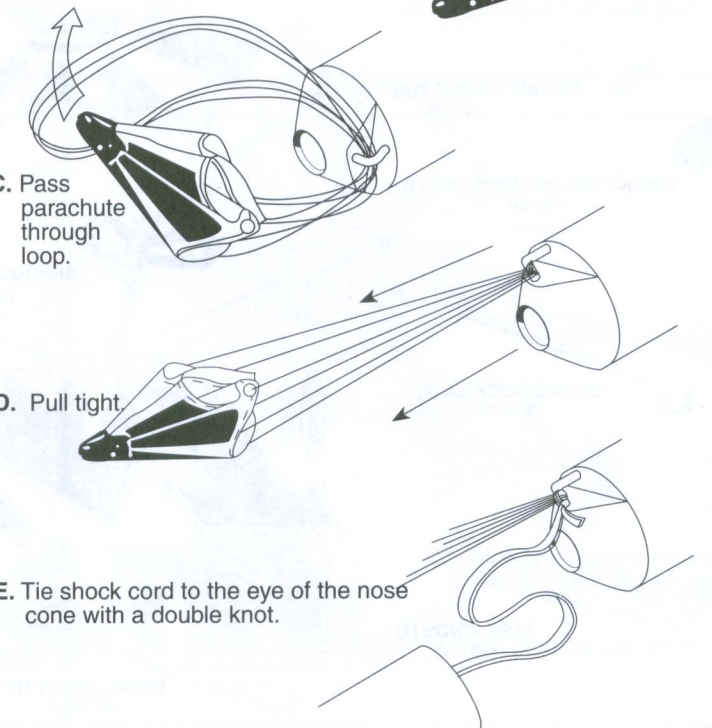

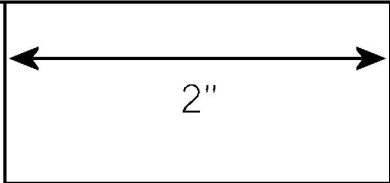
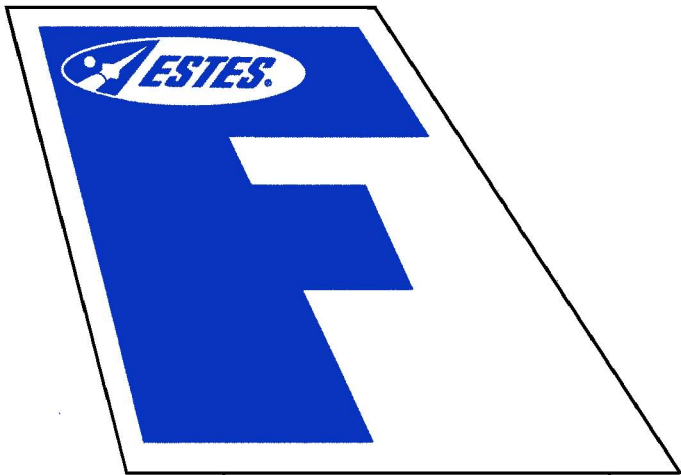

Note: This pattern is based upon the decal size/shape, it is not a tracing.

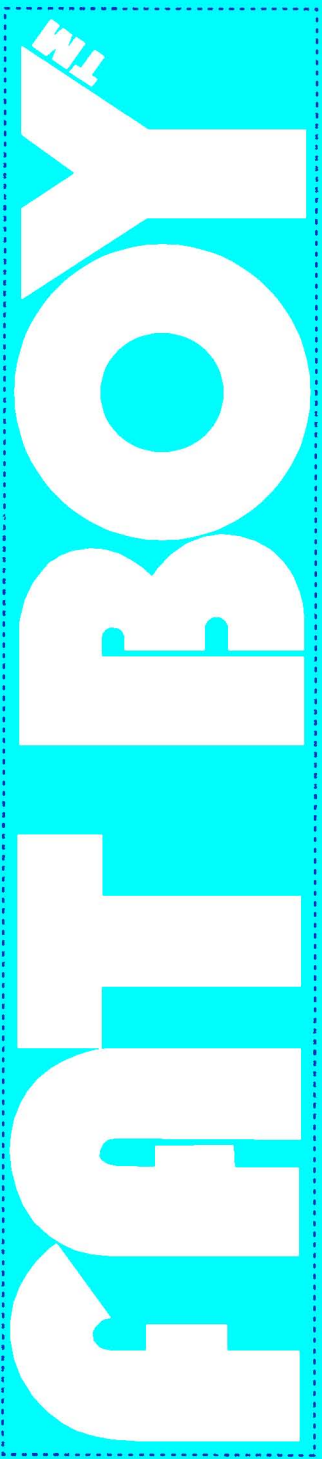

CUT INSIDE  
DOTTED LINES



PN 37728